



KV1129

Center Under Mount Drawer Slide - 35# Rating

INSTALLATION INSTRUCTIONS FOR THE KV1129 DRAWER SLIDE

Note: When replacing existing drawer slides, confirm that the new slide:

- has a load rating that will accommodate the anticipated drawer load
- used a similar mounting style
- is the correct length
- will fit within the available clearance between drawer and cabinet

Each package contains:

- 1 cabinet member
- 1 drawer member
- 1 rear mounting bracket
- 2 plastic tack glides
- 4 flat-head screws (#6 x $\frac{5}{8}$ ", KV#200281)
- 2 pan-head screws (#7 x $\frac{1}{2}$ ", KV#200143-4)

1/4" clearance is required beneath the drawer. (A shim may be used under the cabinet member to adjust for clearances greater than 1/4")

Note: For drawer slide installation in new cabinets, skip to the "Installation - New Cabinetry" section.

Installation - Existing Cabinetry

1. Remove the drawer.
Remove the contents from the drawer and remove it from the cabinet.
2. Remove the existing drawer slide(s) from the drawer and cabinet.
3. Prepare the cabinet and drawer to accept new drawer slide. Fill holes, sand rough spots that might interfere with mounting new drawer slides, and make any other needed repairs.

See the "Installation - New Cabinetry" section.

Installation - New Cabinetry

1. Preparation.

To separate the two slide members (the wide section is the cabinet member; the narrow section is the drawer member), pull the drawer member about halfway out. Rapidly and force-

fully continue opening the slide; the two slide members will separate.

Measure the width of the drawer box and mark the center line from front to back on the underside of drawer. Measure the face opening of the cabinet and mark a center line from the cabinet opening to the back of cabinet.

2. Install drawer member.

Position the drawer member over the center line of the drawer underside, with the front of the slide flush with the rear of drawer front. Using a flat head screw, fasten the slide to the area behind drawer front. Then select the slide hole nearest to the center of drawer back, and fasten with one screw.

3. Install cabinet member.

Position the cabinet member over the center line of cabinet opening, with the front of the slide flush with cabinet opening. Using a flat head screw, fasten the front of slide. After determining that the slide is level, fasten the bracket to the rear of cabinet, using one pan head screw through the horizontal slot in the bracket. Mount a plastic tack glide on top of either side of the front rail.

Note: If the cabinet has a horizontal stringer, you may discard the rear mounting bracket, and mount the cabinet member directly to the stringer.

4. Insert, adjust, and secure.

Insert the drawer, by placing the drawer member between the ball bearings and carefully pushing the drawer until it is closed.

If the drawer feels tight, loosen the front mounting screws of the cabinet member and insert a shim beneath it. Recheck all screws and tighten as needed.

Check that the drawer stops at the fully opened position. The drawer should not easily pull completely out of the cabinet.

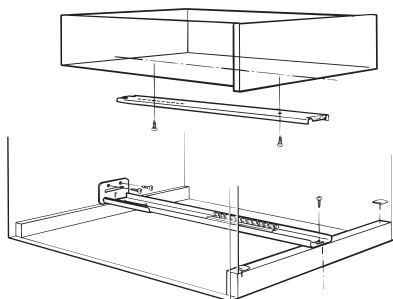
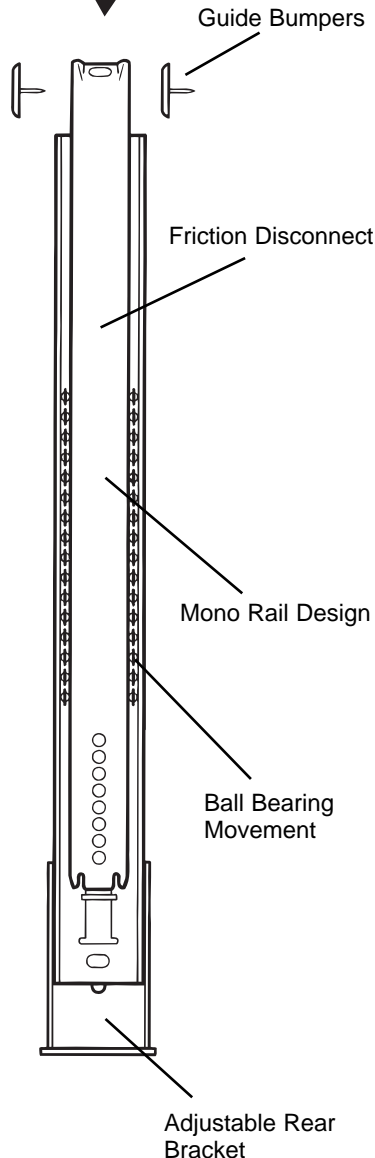

Drawer Slide Mounting Profile

