

Boring Pattern

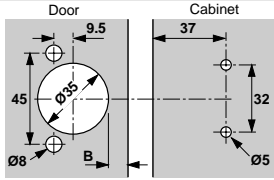

Minimum Reveal

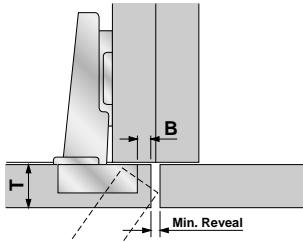

B	T	16	18	19	20	22	24
3	3	1.2	1.7	2.0	2.4	3.3	4.5
4	4	1.2	1.7	2.0	2.3	3.1	4.2
5	5	1.1	1.6	1.9	2.2	3.0	4.0
6	6	1.1	1.6	1.9	2.2	2.9	3.0

Table applies to all applications

Cross reference the door thickness (T) to the boring distance (B) on your application to find the minimum reveal

For mounting plates see page C-30 - C-31

Overlay Applications

Straight Hinge

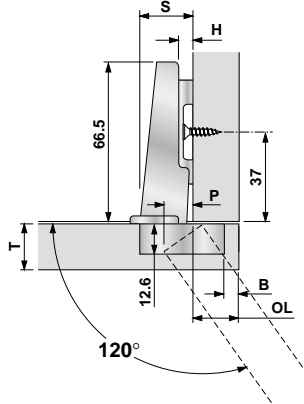

Half Cranked Hinge

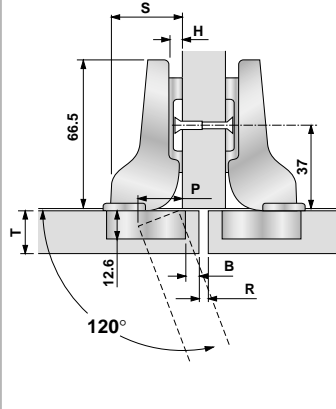

Inset Application

Half Cranked Hinge

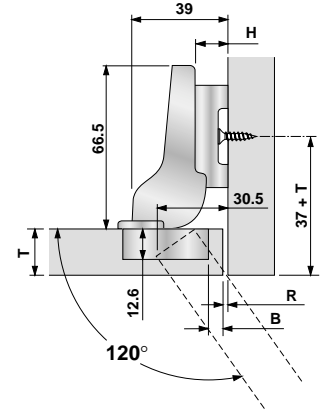

H Plate Ht.	B Bore Distance						Interior Clearance	
	3	4	5	6	P	S		
0	14	15	16	17	11.5	20.5		
3	11	12	13	14	14.5	23.5		
6	8	9	10	11	17.5	26.5		
9*	5	6	7	8	20.5	29.5		

Fixed Distance (X) = 11

H Plate Ht.	B Bore Distance						Interior Clearance	
	3	4	5	6	P	S		
0	4.5	5.5	6.5	7.5	21.5	30		
3	1.5	2.5	3.5	4.5	24.5	33		
6			5	1.5	27.5	36		

Fixed Distance (X) = 1.5

Overlay (OL) = Boring Distance (B) + Fixed Distance (X) - Plate Height (H)
OL = B + X - H

H Plate Ht.	B Bore Distance					
	3	4	5	6		
9	4.5	3.5	2.5	1.5		

Fixed Distance (X) = -7.5
Reveal = H + (X = B)

R= Reveal
X= Fixed distance
B= Boring distance
H= Plate Height

Alternate hinge & mounting plate:
any straight hinge + 18mm plate

Swing Type

Cup Mount

* Self-Closing

Screw-on

B071T5550

B071T5650

B071T5650



Press-in

B071T5580

B071T5680

B071T5680

INSERTA

B071T5590

B071T5690

B071T5690

Free-swinging

Screw-on

B070T5550

B070T5650

B070T5650



Press-in

B070T5580

B070T5680

B070T5680

INSERTA

B070T5590

B070T5690

B070T5690