

Warning! Buyer/user assumes all responsibility for safety and proper use not in accordance with the directions and safety labels.

Rio POWER CO₂+ AQUA PLANT SYSTEMS REACTOR & SURFACE SKIMMER



NOTE: Package will only include either suction cup bracket or magnet mount.

FEATURE

- Power Surface Skimmer
- Produces Ultra-Fine CO₂ Bubbles
- Carbon Dioxide Reaction Chamber
- Connects Easily To Any CO₂ Source
- Injects CO₂ Evenly And Efficiently
- Clog Resistant Venturi
- Simple And Easy Up
- Patented

AVAILABLE MODELS

Item No.	Description	Aquarium Size	UPC No. 0006760
F-5001	Rio 90 Power CO ₂ + With Suction Cup Bracket	< 24" (60 cm)	1455 4
F-5001M	Rio 90 Power CO ₂ + With Magnet Mount		1456 1
F-5002	Rio 200 Power CO ₂ + With Suction Cup Bracket	> 36" (90cm)	1459 2
F-5002M	Rio 200 Power CO ₂ + With Magnet Mount		1460 8

1

WARNING & SAFEGUARDS

Read and follow the guidelines to ensure the proper use and application of this Rio® Power CO₂+. Failure to follow these guidelines may result in damage to the aquatic environment and serious injury.

Operation and safety Precautions

The National Code requires that a GFCI (Ground Fault Circuit Interrupter) be utilized in the branch circuit supplying all water pump and aquarium electrical equipment. If you do not have a GFCI, please see your local electrical supplier for this device.

Important Warning and Safeguards

- Do not operate pump with Rio® Power CO₂+ without being fully submersed at all times. Not doing so can cause permanent damage to the pump.
- Replace the impeller and or shaft if there is any excess signs of wear.
- Prior to maintenance on any electrical aquarium appliance or maintenance to the aquarium, you must disconnect all electrical aquarium devices.
- Routine maintenance is required to ensure the maximum performance and the longevity of Rio® Power CO₂+. See Maintenance Guidelines.
- The national code requires all aquarium equipment to be plugged into a

2

GFCI (Ground Fault circuit Interpreter) electrical outlet.

- Do not operate if wire is damaged.
- Do not plug into an extension cord.
- Failure to use the main housing strainer and or filter conversion kit may allow sand and or debris into the impeller chamber thus causing permanent damage to the impeller, ceramic shaft and or the pump.
- Do not plug into a power strip. Always plug the pump directly to a GFCI outlet using a drip loop.
- Rio® Power CO₂+ is designed to run completely submerged in water. Do not operate pump outside of water! This pump should be submerged in water before connecting to a power source.
- Start Pump in Water ONLY. DO NOT run pump in air.
- Rio® Power CO₂+ may be utilized in either fresh water or salt water but not in foreign fluids, flammable liquids or any chemical.

Warning!

This product may contain chemicals known to the state of California to cause cancer and or birth defects or other reproductive harm. Wash your hand after handling this product.

3

It is your sole responsibilities to verify that the plug and the receptacle are clean and free of moisture and salt build up at all times. The receptacle must be free of water, salt, calcium, magnesium and dust. Failure to do so can cause fire, damage to property, permanent damage to the product and personal injury not limited to loss of life.

Do not plug into extension cord/ power strip.

A drip loop must be used when plugging all electrical aquarium devices. A drip loop is that part of the cord hanging below the receptacle.

The national code requires that a GFCI (Ground fault circuit interrupter) be used in the branch circuit supplying all power to water pumps and electrical aquarium equipment. If you do not have a GFCI, have an electrician install one prior to operating any aquarium component.

Note: It is important that the right pump and flow rate is being used for the given specific application. Use the flow chart to determine the proper size pump and tubing to be used for given application.

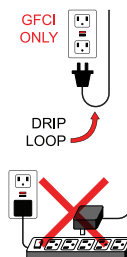

4

Warnings! Magnet mount

Very strong magnet! Not a toy- Keep out of reach of children- Failure to do so will cause serious injury and or permanent damage to your aquarium.

- Keep out of reach of children.
- Do to the strength of the magnets they will attract other metals or magnets with force. When installing or handling magnets there must not be any other magnets or metals in close proximity to the magnet holders. Failure to do so will cause serious injury.
- Keep away from devices sensitive to magnetic fields such as pacemaker, data carriers, credit cards, electronic equipment and medical devices. Failing to do may result in permanent damage to such devices.
- Never allow magnets to snap together.
- Always handle magnets one at a time. Once separated keep a min. of 12" apart.
- Hold magnets only by the sides. Never get your fingers or hands between the contact services.

Caution: When using carbon dioxide in any aquatic environment special equipment, test kits will be required and attention from the user. Carbon dioxide will drastically affect PH levels in the aquarium and if not properly monitored will cause loss of life in any aquatic environment.

5

PART LIST

1. Motor
2. Impeller
3. Impeller well cover
4. bushing
5. Shaft
6. CO₂ reaction chamber
7. Foam pre filter
8. Suction cup bracket
9. Magnet mount
10. Flare discharge
11. Air stopper
12. Surface skimmer
13. Flow control collar
14. Strainer

CO₂ source is not included

NOTE: Package will only include either suction cup bracket or magnet mount.

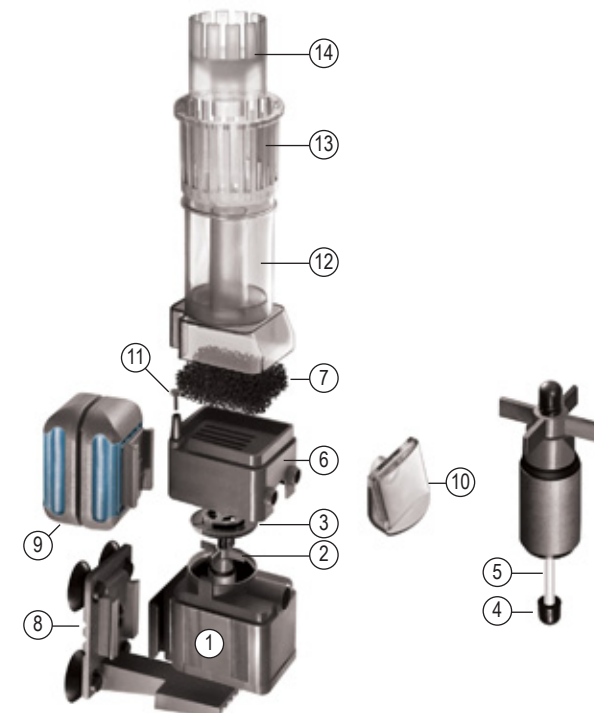

6

INSTALLATION:

1. Choose a location for the CO₂ reactor.
2. Verify that the glass is clean.
3. Secure to the aquarium using either the provided suction cup bracket or magnet mount.



4. Adjust the unit so that the water level is a 1/2" from the brim of the surface skimmer.
5. Soak the strainer in water and make sure there is no bubble remain underneath the strainer. The strainer should float easily. (If water doesn't flow into the strainer, softly press the strainer down in water and release.
6. Carbon dioxide set up: There are many ways to provide carbon dioxide to the pump. If there are any concerns

7

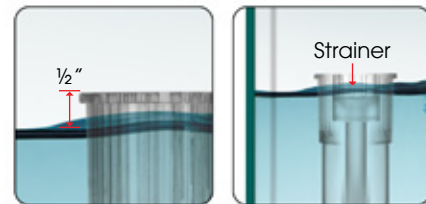

in the initial set up always consult your local tropical fish store prior to installation. Follow all manufactures guidelines and precautions when connecting the carbon dioxide source.

- (a) Remove the air stopper.
- (b) Connect a piece of silicone airline tubing to the carbon dioxide inlet.
- (c) Install in an inline check valve.
- (d) Connect piece of silicone airline tubing from the check valve to a bubble counter.
- (e) From the bubble counter connect another piece of silicone airline tubing from the bubble counter to the carbon dioxide source.

7. Plug pump directly to a GFCI outlet.
8. Turn on carbon dioxide source.
NOTE: Do not remove air stopper if using the unit as surface skimmer ONLY!

8



MAINTENANCE

Pump

Preventing debris and free floating material from entering your Rio® Power CO₂+ is of utmost importance to the longevity of your pump. Your pump requires regular cleaning to maintain a steady water flow. Note: Gravel, sand and calcium deposits will also diminish/damage the longevity of Rio® Power CO₂+ and impeller.

1. IMPORTANT: You must disconnect all electrical power to the aquarium and water pump before beginning the maintenance on any electrical equipment including Rio® Power CO₂+.
2. Disconnect the silicone airline tubing from the pump.
3. Do not use any soap or detergents.
4. Remove the surface skimmer and strainer.
5. Remove the CO₂ reaction chamber.
6. Rinse and clean sponge.
7. Remove the impeller well cover.
8. Caution when removing the impeller be careful that you do not misplace the rubber bushings that are

9

attached to the shaft. Remove the impeller and the shaft clean all grim and debris. Verify that the impeller spins easily on the shaft. If there is any signs of damage or excess wear to the impeller and or the shaft replace complete impeller assembly.

9. With a small brush clean the inside of the impeller well.
10. Reassemble the unit.
11. Impeller may need to be replaced periodically to maintain a steady output flow. Rio® Power CO₂+ replacement parts, are sold at your local pet dealer or call us, TAAM® for more information for purchasing Rio® Power CO₂+ replacement parts.
12. Do not tamper with or replace the power cord of this appliance. If the cord is damaged, the appliance should be discarded.

Surface Skimmer and Strainer

They need to be clean regularly to insure proper water flow to the pump. Remove the surface skimmer and strainer and clean well with water. Remove all algae build-up and debris with a small brush.

10

LIMITED WARRANTY

TAAM® warrants that Rio® Power CO₂+ is free from defects for a period of 6 months from the initial date of purchase shown on the original cash register receipt. TAAM® disclaims all other warranties of merchantability and/or fitness for a particular purpose. Although this limited warranty may give you specific rights, you may have other rights that may vary from state to state. This warranty is void if the failure of the pump or any part, sealant or component there of is due to (i) misuse, (ii) tampering, (iii) negligence, (iv) misapplication, (v) abuse, (vi) accident and/or (vii) failure to properly (a) maintain, (b) clean, (c) keep pump fully submersed and/or use the pump with a Ground Fault Circuit Interrupter (GFCI).

CONSUMER REMEDIES

TAAM®'s entire liability and your sole and exclusive remedy shall be either repair or replacement of Rio® Power CO₂+ only if you return the defective unit directly to TAAM® with the original receipt in its original box along with seven dollars (\$7.00) for shipping and handling. Do not send Rio® Power CO₂+ by insured mail. You may send your returns or replacements by UPS if requiring a signature upon arrival. Any replaced unit will be warranted for the remaining time of the original warranty period. In no event shall any shipping charges be reimbursed. In no event will TAAM® be liable for any consequential or incidental damages, including but not limited to, lost sea life, personal injury, property damage, equipment damage, lost profits, lost wages, lost savings, lost income, etc., arising out of the use of Rio® Power CO₂+. Some states do not allow for the limitation or exclusion of liability for incidental or consequential damages, so the above exclusion may not apply to you.

11

RETURNS

Please contact our service center at (805) 383-3566 ext. 102 or fax (805) 383-3566 to arrange repair and/or replacement. Please allow 4-6 weeks for all returns.

WARRANTY CARD

Please go to our website, to download Warranty Card.

http://www.riopump.net/Resources_folder/Warranty.html

Fill out this warranty card and mail it with PROOF OF PURCHASE within 15 days of purchase.

TAAM®

Technological Aquatic Associated Manufacturing
Fax: (805) 383-3566

Rio Production@.85-1, Shuiyuan Rd., Taipei, Taiwan
Fax: 886-2-23688205

WWW.RIOPUMPS.COM

©2013 TAAM®
Specifications & technical information may change without notice

12